



Specialists in ELV Systems



COMFORT | SAFE | SECURE

www.edgetechnicalsolutions.com



Our Project Highlights:

- Nassima Tower Hotel, Dubai
- Carrefour, Dubai
- ACICO Business Park, Dubai
- Radisson Fujairah Resort & Spa
- Zayed University, Dubai
- Somewhere Hotel, Dubai
- Royal Amwaj Spa, Dubai
- Al Jalila Hospital, Dubai
- Al Wasl Buildings, Dubai
- Kandahar Library, Afghanistan
- Data Centers, Pakistan
- SEWA Power Station, Sharjah
- 10 Staff Accom. Bldg. DWC, Dubai
- CMW, Warsan, Dubai
- Oasis Mall, Bahrain
- Four Points Sheraton, Sharjah
- Le Meridien, Abu Dhabi
- Zayed Military, Abu Dhabi
- Anantara Spa - Palm Jumeirah, Dubai
- Al Malki Head Quarters, Qatar
- Palm Jumeirah Marina Residence, Dubai
- Horizon School, Dubai
- Social Care Village, Umm Al Quwain
- DEWA Substation, Dubai
- Hilton, Abu Dhabi
- 5 Luxury Buildings in Exhibitions City, Dubai
- Sultan Qaboos University, Oman
- ADNOC, Fujairah
- Citygate Tower, Sharjah
- Tabuk Air Base, KSA

EDGE Technical Solutions LLC is an ISO 9001:2008 certified company specializing in all low voltage systems including Fire Alarm, Emergency Lighting System, Access Control Systems, Building Management System, Lighting Control and Dimming systems and offers full service to its customers from consulting, design, supply, installation and commissioning as well as servicing of those systems. We have grown with the aim of providing integrated solutions for building automation, fire safety, security and broadband communication to change to We have grown with the aim of providing integrated solutions for building automation, fire safety, Gas Detection & safety communication.

With over 10 years of expertise, EDGE Technical Solutions is a growing leader in building automation and as a low current systems integrator. We are exclusive agents of well known manufacturers and respected in their individual fields for the quality and reliability of their products. This coupled with our own Technical staff executing projects to International Standards, has earned the Company an excellent reputation over the past years.



All our products are LPCB, UL, TUV, VDS or BSI Kitemark approved. We are also listed with regional Civil Defense authorities for our products and services. With Regional offices in Qatar & KSA, EDGE Continues to support the entire Middle East region with its technical expertise & local stocks. We are also class - A certified fire alarm system contractor in dubai for executing any size of building, Projects, Fit-outs and Maintenance Jobs.



CONTENTS

POTTER	04
ELOTEC	07
FIREHAWK	08
MACURCO	08
CAREHAWK	09
DENKO	10
GESSLER	11
EXILIGHT	12
FUTRONIX	13
FIREVIEW	13
FIDELIX	14

Our Mission

"To maintain a leadership position in providing Integrated Solutions to building automation, fire, safety & security systems providing customer focus with Quality, Service & Safety".

Our Products are listed with



Civil Defense General Directorate

Abu Dhabi | Dubai | Sharjah



SAUDI ARABIA



KUWAIT



QATAR



OMAN



BAHRAIN

Civil Defense

Our Principals are:



Class A Certified Company for Annual Maintenance Contract



EDGE Technical Solutions is the agent in the Middle East and Africa for POTTER fire alarm systems which includes both Conventional & Addressable Fire Alarm system solutions. Innovative and market leading designs ensure that POTTER Signal Fire Alarm system always provide cost-effective and reliable solutions to a wide range of fire detection applications.

The new IPA range includes the following key advantages

- Range from 60 to 4064 Addressable Devices on One panel
- Ethernet connectivity to receive / send Emails
- Loop Card Partability Reducing Cabling Cost
- DIP switch addressing for easier maintenance
- 5 Years warranty
- UL listed made in USA

Email Capabilities

The POTTER Fire panels are email ready. History and Detector Status reports can be sent on demand as either a text or Excel® file for a professional look. The status events of the panel can be immediately emailed allowing users to be proactive in servicing customers. Reports and the configuration file can be requested from the panel at any time by sending an email directly to the panel. All these capabilities provide a more efficient way to monitor multiple systems.



E-mails can be sent directly to the panel for status updates or to download configuration files.

Ethernet Connectivity

The POTTER Fire panels have the ability to connect to a Local or Wide Area Network (LAN or WAN) and obtain an IP address. The panel configuration software allows custom programming and configuration for all points using the network or a standalone computer. At the click of a mouse, you can fine-tune device behavior characteristics or create mapping zones for a more sophisticated fire protection system.



Ethernet connection allows for programming from a standalone or networked computer

POTTER Voice Evacuation

The POTTER PVC High Rise Evacuation System operates in conjunction with the Fire Alarm Control Panel (FACP) in a building to provide automatic response to life safety emergencies. The POTTER PVC includes all necessary features to provide an effective voice evacuation system. The POTTER PVC can be custom configured to satisfy the needs of any high rise application.

The PVC system includes capacity for 6 channels of simultaneous audio. This provides for evacuation, stay-in-place, or other public address announcements and automatic messages. Fire Fighter Phones or Warden Stations may be included as required.

Panel Connections

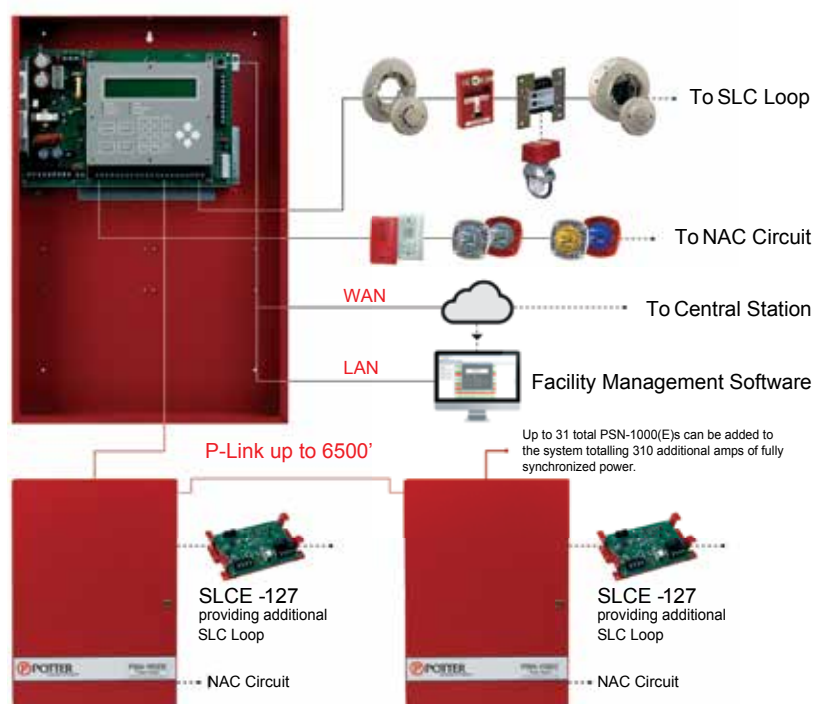

Alarm Monitoring Centre

- Remote Monitoring Software
- Monitor Easiest Route to Fire Location
- IOS /Android App Based S/W
- Map Based Software

POTTER Explosion Proof Devices

POTTER Signals provides a wide variety of Explosion proof devices like Explosion Proof detectors, Horns, Strobes, Switches, Pull Stations etc to be used at highly hazardous (Explosive areas) complying all the safety requirements for such conditions.

Features

- True Multiplex 6 Channel Networked Audio
- Integrated Fire Phone capable
- Modular System - components added as needed
- Integrated 2 Channel Digital Message Repeater
- Live Microphone Page to any zone
- Fast RS-485 Communication Protocol
- Fully Supervised
- Easy Installation and Operation
- Natural Sound Voice Recordings
- Built in Alarm and Alert Signals
- Up to 4 Minute Message Capacity
- Works with 12VDC or 24VDC Fire Alarm Panel
- Microprocessor based Voice Evacuation panel
- 2 Minute Message Restart on Microphone Key
- Made in the USA.



Fire Sprinkler Monitoring

Established in 1898, Potter Electric Signal Company has earned a reputation worldwide as an elite provider of goods and services. Potter produces a wide array of products including fire sprinkler monitoring systems, electronic fire systems, and vault and safe security systems. With more than 110 years of sprinkler monitoring experience, Potter is also the trusted source for corrosion testing, monitoring, and treatment with our comprehensive suite of corrosion solutions.

FLOW SWITCHES

Water Flow Alarm Switches

- Non-Corrosive Saddle Bushing eliminates water to metal contact stopping the possibility of corrosion
- NEMA 4 solid metal enclosure
- Factory installed neoprene gasket
- 0-90 second field replaceable pneumatic retard
- 450 psi system pressure rated
- Synchronized switch action
- Available in Explosion Proof Models
- 5-year warranty
- Listings: UL, cUL, FM, LPCB, CSFM, NYMEA, and CE



PRESSURE SWITCH

Pressure Type Waterflow Alarm/Supervisory Switch

- NEMA 4 solid metal enclosure
- Factory installed neoprene gasket
- Pressure range 4-15 psi
- 300 psi system pressure rated
- 1/2" male NPT fitting
- Separate isolated wiring chambers
- Factory set for operation at:
 - Pressure Increase at 6 psi
 - Pressure Decrease at 5 psi
- Available in Explosion Proof Models
- 5-year warranty
- Two 1/2" knockouts for dual voltage applications
- Listings: UL, cUL, CSFM, FM, LPC, NYMEA, and CE



OSYSU-1 & 2

Outside Screw & Yoke Valve Supervisory Switch

- NEMA 6P (Submersible)
- Factory installed neoprene gasket
- Fits 1/2"-12" valves
- Installs on OS&Y valves in any position
- Available in Explosion Proof Models
- 5-year warranty
- Listings: UL, CUL, CSFM, FM, NYMEA, and CE



PFC-6006

Sprinkler Monitoring Panel

- 6 Programmable Initiating Device Circuits
- Class A or Class B Waterflow Initiating Circuit
- 1.0 Amp Power Supply
- 0.5 Amp Auxiliary Power, Programmable as Constant or Resettable
- 2 x 16 LCD display with system LEDs for clear system status
- Built-in Ethernet Connection with listed IP Communicator
- Ability to E-mail system status, reports and system configuration
- Service Reminder E-mails



PFC-4410RC

Conventional Releasing panels

- Preaction, deluge, or clean agent releasing
- Single or multi-hazard capability
- 23 standard install programs with optional programming



IPA 60/100/4000

Addressable Releasing Panel

- Preaction, deluge, or clean agent releasing
- Single or multi-hazard capability
- Built-in Ethernet Connection with listed IP Communicator
- Ability to E-mail system status, reports and system configuration
- Service Reminder E-mails





Elotec AS is an ISO9001 certified company manufacturing Air Sampling Smoke detection system & wireless addressable fire alarm systems. Elotec's range of Vds certified Aspect series of Air sampling smoke detection systems have been installed in more than 10,000 projects across Europe & Middle East.

Air Sampling Smoke Detection System

Aspect series of Air sampling smoke detection system employs advanced technology In smoke detection for special applications including data centers, warehouses, workshops, cold & freezer rooms etc where spot type smoke detectors are not possible to be installed due to high amount of dust or temperature related parameters. Aspect series includes 3 range of panels namely Lazeer, Grizzle & Nitro which covers all the 3 types A,B & C type sensitivity. The special printed drilling line, smoother bends, capillary tubes, Sampling holes for false ceiling (sniffers) & clips completed the range of accessories required for any every type of installation requirement. A very innovative Mobile application helps in commissioning & troubleshooting for the customer as well.



Wireless Addressable Fire Alarm System

Elotec provides a fully EN54 compliant addressable wireless fire alarm system approved by Intertek Laboratory. Upto 240 wireless devices can be connected to wireless fire alarm control panel. The entire system includes wireless detectors, input & output modules, sounders & pull stations which covers the entire requirement for a fully comprehensive wireless fire alarm system.

System Overview

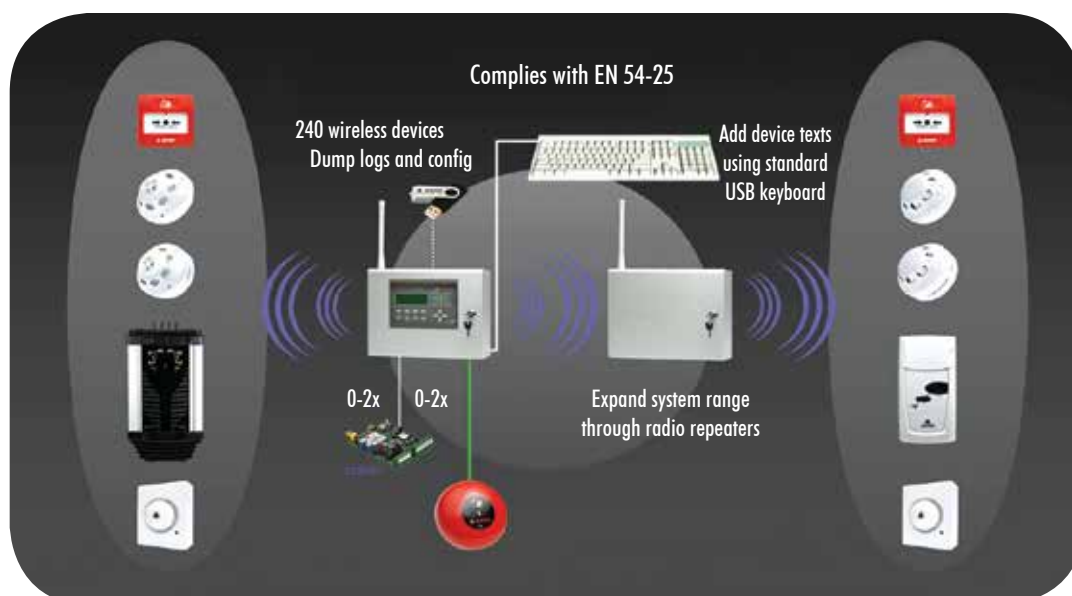



**From Fireblitz
Extinguisher Ltd.**

The new and exciting FIREHAWK range of Fire and Carbon Monoxide alarms is a boost product range which EDGE provides in the MENA region. The range includes our FHB10 Long Life battery operated smoke alarms, the FH250 and FH450 range of mains powered smoke and heat alarms with battery back-up and rechargeable lithium options and the CO7 range of Carbon Monoxide alarms: all approved to the most up to date European standards by the Building Research Establishment and British Standards Institute (BSI).

The main models are :

- **FHB10/10i-Long Life** Lithium Battery Powered Optical Smoke Alarm (Inter linkable feature)
- **FHH10/10i- Long Life** Lithium Battery Powered Optical Heat Alarm (Inter linkable feature)
- **FH250-Mains Powered Smoke Alarm** • **FH450- Mains Powered Heat Alarm**
- **FHB10W-Wireless Battery Operated Smoke Alarm**
- **FHH10W-Wireless Battery Operated Heat Alarm**
- **CO7-Battery Operated Carbon Monoxide Alarms**
- **FH500R- Relay Base for Mains Powered Detectors**
- **FBST-1 Single Extinguisher Stand** • **FBST-2 Double Extinguisher Stand**
- **Deaf Alarm** • **Tester/silence switch (AL-TH)**



Headquartered in Sioux Falls, South Dakota, Aerionics, Inc. manufactures the Macurco fixed gas detection product line. Aerionics strives to provide the highest quality gas detection, safety and security solutions to customers worldwide.

The Macurco product line offers fixed gas detection equipment for residential, commercial and light industrial applications. There are fixed gas detection options for a number of different gases including carbon monoxide, nitrogen dioxide, hydrogen, LP and natural gas. The Macurco product range have application sinco Carpark Monitoring Systems, Portable Gas Detection Systems, Explosion Proof Detection & Residential Gas Detection Systems.



Residential Gas Detectors	Industrial & Commercial Detectors
CO Gas Detector Combustible Gas Detector Hydrogen Gas Detector	CO Gas Detector Combustible Gas Detector Nitrogen Dioxide Gas Detector H2S Gas Detector Ammonia Gas Detector CO2 Gas Detector



CAREHAWK is an ISO 9001 company from Canada specializing in solutions for safety communications. These communication systems are having huge applications in the field of Medical, Security & Weather Emergencies. The heart of the system is the powerful CH1000 controllers, which has 2 Nos. of inbuilt 300W amplifier & different audio, Telephone & Intercom ports. The switching cards help to distribute the field terminations from speakers, Telephones etc & thus reducing cabling. Other solutions from CARE HAWK include:

- Master Clock System
- Nurse Call System
- District Wide Paging
- Background Music System
- Classroom Intercom System
- Public Address System





Established in 1992, Denko Lighting Pte Ltd specializes in the design, development and manufacture of innovative emergency lighting, exit signs and related products. As one of Singapore's leading manufacturers in the emergency lighting market, Denko Lighting takes pride in product quality, reliability and innovation of emergency lighting products to meet and exceed the needs of both local and overseas customers. Denko Lighting's products are listed under the Product Listing Scheme - a safety and product quality certification accredited by TÜV SÜD PSB Singapore - which bears the mark of excellence as required by international standards.

Self Contained Emergency & Exit Light



Model No: SLED/EMEX Series W1201M/RM
Lamp: 1 W High Flux White LED
Mount: Surface/Recessed/Hanging/Wall
IP Rating: IP 20



Model No: BLEX W2001M/RM
Lamp: 1 W High Flux White LED
Mount: Surface/Wall /Pendant
IP Rating: IP 20



Model No: WLEX IOOM/RM
Lamp: 2 W High Flux White LED
Mount: Wall /Pendant
IP Rating: IP 65



Model No: LED-11NM/13NM (SURFACE)
Lamp: 1 W/3 W High Flux White LED
Mount: Ceiling/Pendant
IP Rating: IP 20



Model No: LED-11NM/13NM
Lamp: 1 W/3 W High Flux White LED
Mount: Recessed
IP Rating: IP 20



Model No: LED-11NM/13NM (ESTA)
Lamp: 1 W/3 W High Flux White LED
Mount: Recessed
IP Rating: IP 20



Model No: EMLED-12NM/14NM
Lamp: 2W/4W High Flux LED
Mount: Recessed
IP Rating: IP 20



Model No: CEL/EMCEL Series
Lamp: 1 W/3 W High Flux White LED
Mount: Ceiling/Wall /Pendant
IP Rating: IP20/IP65



Model No: DL 2018NM
Lamp: 2 X 1 High Flux White LED
Mount: Wall/Pendant
IP Rating: IP 20



Model No: DL2301 NM
Lamp: 2X1 High Flux LED
Mount: Wall/Pendant
IP Rating: IP 20/IP65



Model No: EMDL 205 NM
Lamp: 6W High Woltage LED
Mount: Wall/Pendant
IP Rating: IP 20/IP65



Model No: LED 1330-M / FL 140M-EV58
Lamp: LED Lamps /4-PIN Fluorescent Lamp
Mount: Inside normal light fittings



3 Hour
Battery Backup



PLS Listed
Emergency
Exit Sign



Push Button
Manual Testing

LED
TECHNOLOGY

N I C D
N I M H

Gessler is a leading German manufacturer of Central battery, exit and emergency lighting solutions. The wide range of high-quality products include central power supply systems, single-battery systems, exit sign and emergency luminaires which are designed to make a bold aesthetic statement. Since 1975 Gessler's headquarters are located in Rodgau, Germany. The different ranges and designs of luminaires helps the client to choose as per architectural and aesthetic requirements. All luminaires are uniquely addressed and are continuously monitored. Different possibilities of interfaces such as BACnet, LON, Webserver etc enables BMS integration and remote monitoring.

Central Battery Panel



System: AC/AC or AC/DC
 Load: 150Kva Maximum
 Output Voltage: 230V AC/DC
 Mixed Installation of Maintained & Non-Maintained Luminaires
 7" TFT Touchscreen
 20 Luminaires/Circuit
 Maximum 40 circuits per sub panel
 Internal LON bus
 IP enabled for Remote Monitoring

Address Module



Range of 2-200 W
 Output Voltage: 230 VAC/DC
 Temp. range: -10° to + 60° C
 Sub Circuit/Switch input monitoring
 * Optional DALI Module

I-Connect 16



Monitoring of upto 10 sub circuits
 LED Status display for ON/OFF condition
 Possibility for 3 phase monitoring

Webmaster



Webserver based S/W
 Multiple panels monitoring over TCP/IP
 Functional Tests from Software



Model Number: DISPLAY 9000
Mounting: Wall/Surface/Pendulum
IP Rating: IP41



Model Number: LED-SPOT LA6
Mounting: Recessed/Surface
IP Rating: IP20/IP40



Model Number: DISPLAY 3000/G6-/F6
Mounting: Recessed
IP Rating: IP20



Model Number: LED-SPOT LS3
Mounting: Recessed/Surface
IP Rating: IP20/IP40



Model Number: LUMINA 2000/16
Mounting: Wall/Surface/Pendulum
IP Rating: IP54/IP65



Model Number: LUMINA 2000/16
Mounting: Wall/Surface
IP Rating: IP54/IP65



Model Number: Display Vision
Mounting: Wall/Recessed/Surface
IP Rating: IP41



Model Number: LED-SPOT LS1
Mounting: Wall/ Recessed /Surface
IP Rating: IP20/IP40



Self Contained Central Monitoring Emergency Lighting System

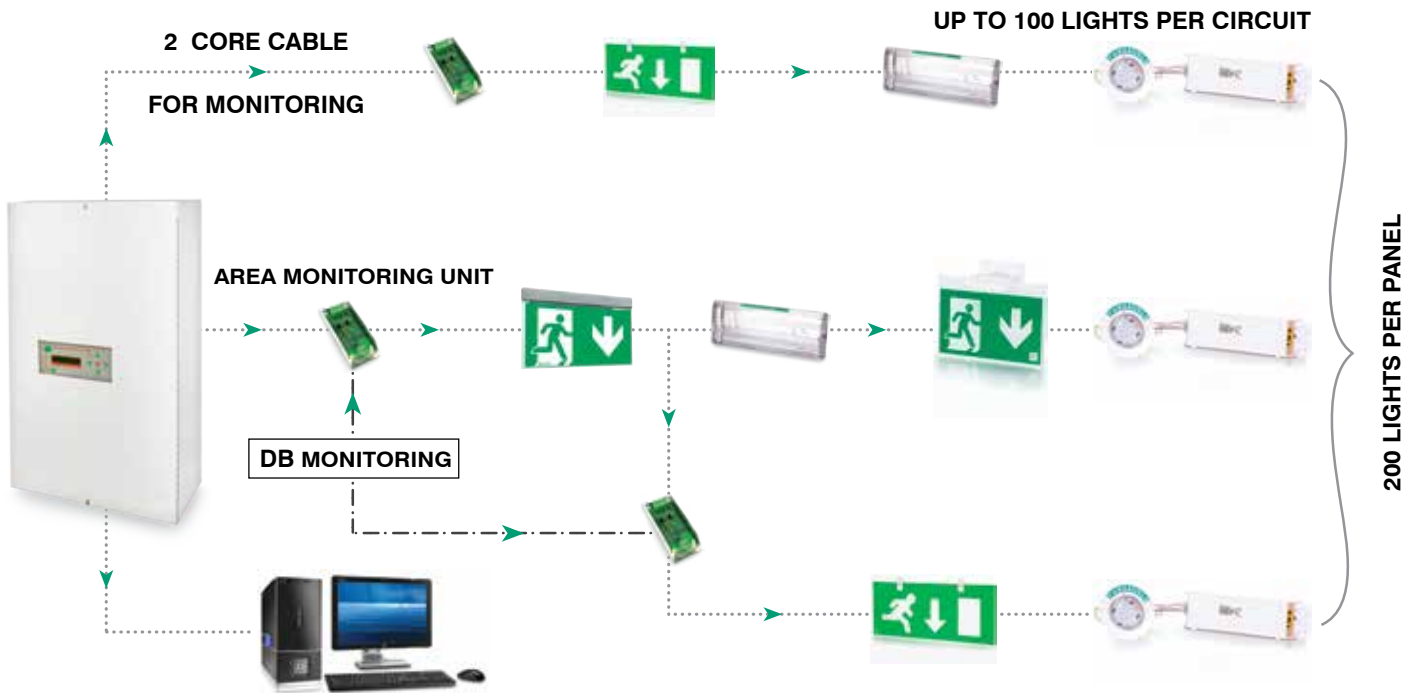

Exilight OY manufactures the industry's widest selection of emergency lighting systems and guide and emergency lights. Exilight is located in Tampere(Finland) in the Technopolis-Hermia business park, and in Espoo at Technopolis-Innopoli. Exilight has the highest AAA credit rating, issued by Soliditet which is acquired only by 4.9% of all companies in Finland

Exilight provides Self Contained Centrally Monitored Emergency & Exit LED lights which makes the installation and maintenance of Self Contained luminaires very simple and cost efficient. Upto 100nos of Addressable Self Contained Emergency/ Exit luminaires are connected on a single circuit with a 2core Cable and thus reducing the overall cabling of the system.

Incorporating High Quality LED products & Lithium Ion Batteries helps in longevity of Exilight luminaires and also helps in reducing maintenance costs. The Area Monitoring unit helps in sub circuit monitoring to switch ON the Non-Maintained Luminaires on the circuit. All products are approved by BSI Kitemark which validates the quality of the product. The panels can also be connected over IP to a Central Control Station for remote monitoring of multiple panels.

- Central Monitoring
- LED EM & Exit Light
- Reduced Cabling
- Low Bus Voltage (60-80V DC)
- LON Compatible
- Area Monitoring
- Battery Duration: 3 hrs
- Up to 200 Lights Per Panel

FUTRONIX

Established in 1989, Futronix has evolved into one of the world's leading manufacturers of lighting control systems.

With installations in over 50 countries, Futronix is recognized by leading architects, designers, engineers and private customers as the product of choice.

Their products range from the world's smallest scene dimmer to the largest commercial system currently available.

Futronix manufactures the only truly digital range of commercial and domestic dimmers. These dimmers have no analogue content, making them smaller, more accurate and more reliable.

The 'Burj Al Arab' is testimony to the flexibility of the PFX system to adapt to the most complex of requirements and meet the highest of standards.



FIREVIEW

Fireview is the world's first unified system combining independent heat and smoke testing functions in one unified tester.

Fireview uses a highly efficient smoke oil which does not affect sensitivity of the detector. Other products from fireview includes.

- **Flame detector testor**
- **Fixed temp. heat detector tester**
- **Customized detector removal tool**
- **6m / 10m extension poles**





Fidelix

Integrated Building Management System



Fidelix is a 25 Year Old Finnish Company providing Integrated Building Management System (IBMS) solutions for more than 1000 projects across Scandinavia & Middle East. Fidelix specializes in web based indoor quality and saves millions of dollars by smart energy management.

Fidelix uses latest web technologies(Html-5) and open IEC 61131-3 standard for PLC programming. The controllers fulfil BACnet B-BC profile and the I/o points are linked via BACnet, Modbus, M-bus, SNMP & OPC. Fidelix uses industrial grade touch screens to provide a long lasting & easy user interface from the DDC panels directly.

Fidelix provides an entire IBMS package which includes:

- Building Management System
- Guest Room Management System
- Lighting Control System
- Metering & Energy Management System
- IP Based CCTV system
- Access Control & Intruder Alarm System

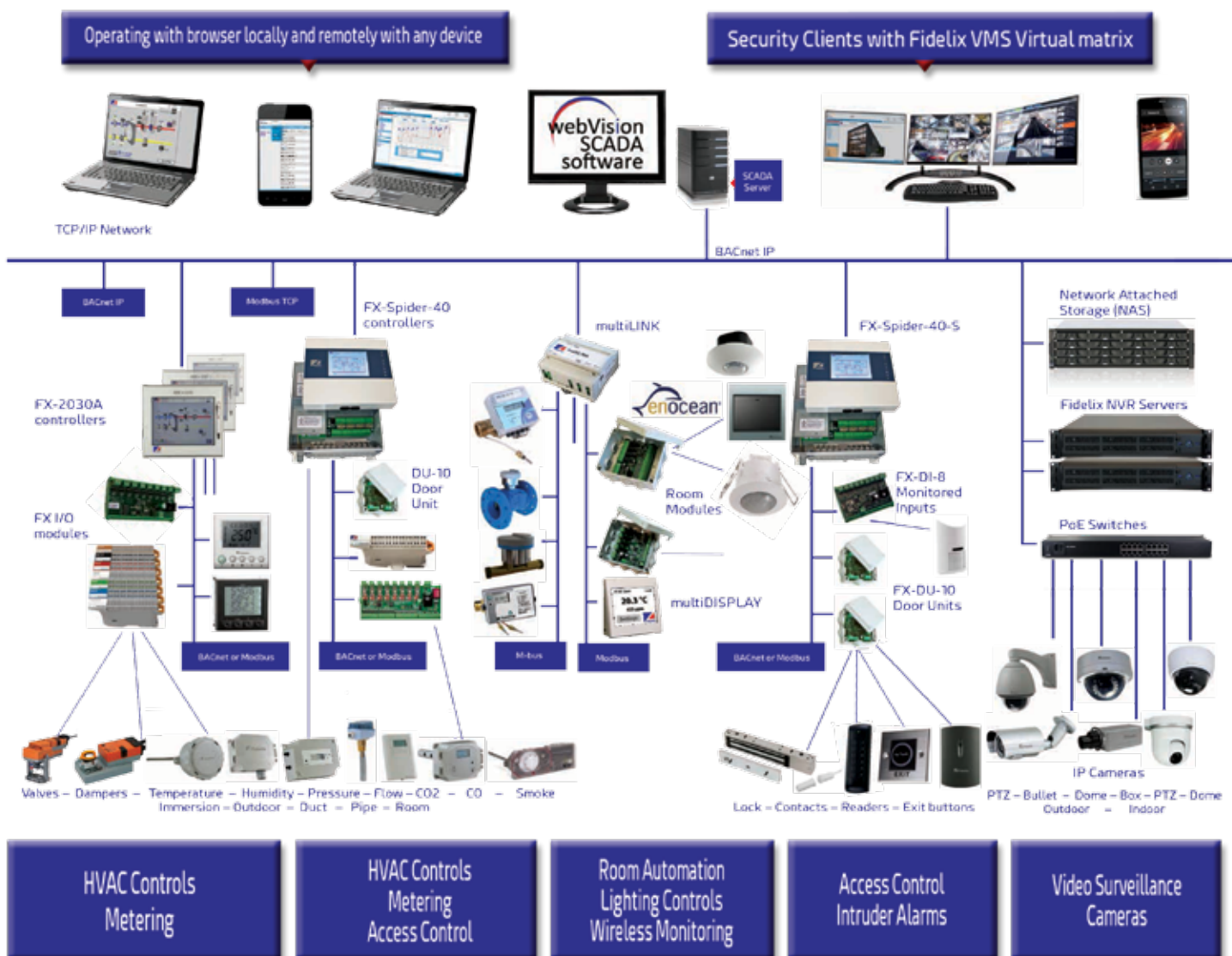

Guest Room Management System

Fidelix IBMS architecture provides Guest Room Management as an integral part of a comprehensive IBMS Solution. GRMS can be seamlessly integrated to Building Management System via Fidelix Central Control Units (CCUs). Basic Solution typically includes Hotel Locks, compatible Energy-Saving Card Holders and thermostats with Energy-Saving features. Energy-Saving Card Holders give permission for the room lighting and thermostat.

To add more features to this basic version, Smart Door Bell System with Do-Not-Disturb & Make-Up-Room (DND&MUR) indoor and outdoor units can be added. Card Holders can also be replaced by occupancy sensors. Balcony door or window contacts can be added to limit/cut off the cooling when doors/windows are left open. Depending on client's requirement, either stand-alone or communicating features can be implemented. Hotel locks have optional Near Field Communication (NFC) feature. This enables guests to use their iOS and Android to devices access their the rooms without keycards.

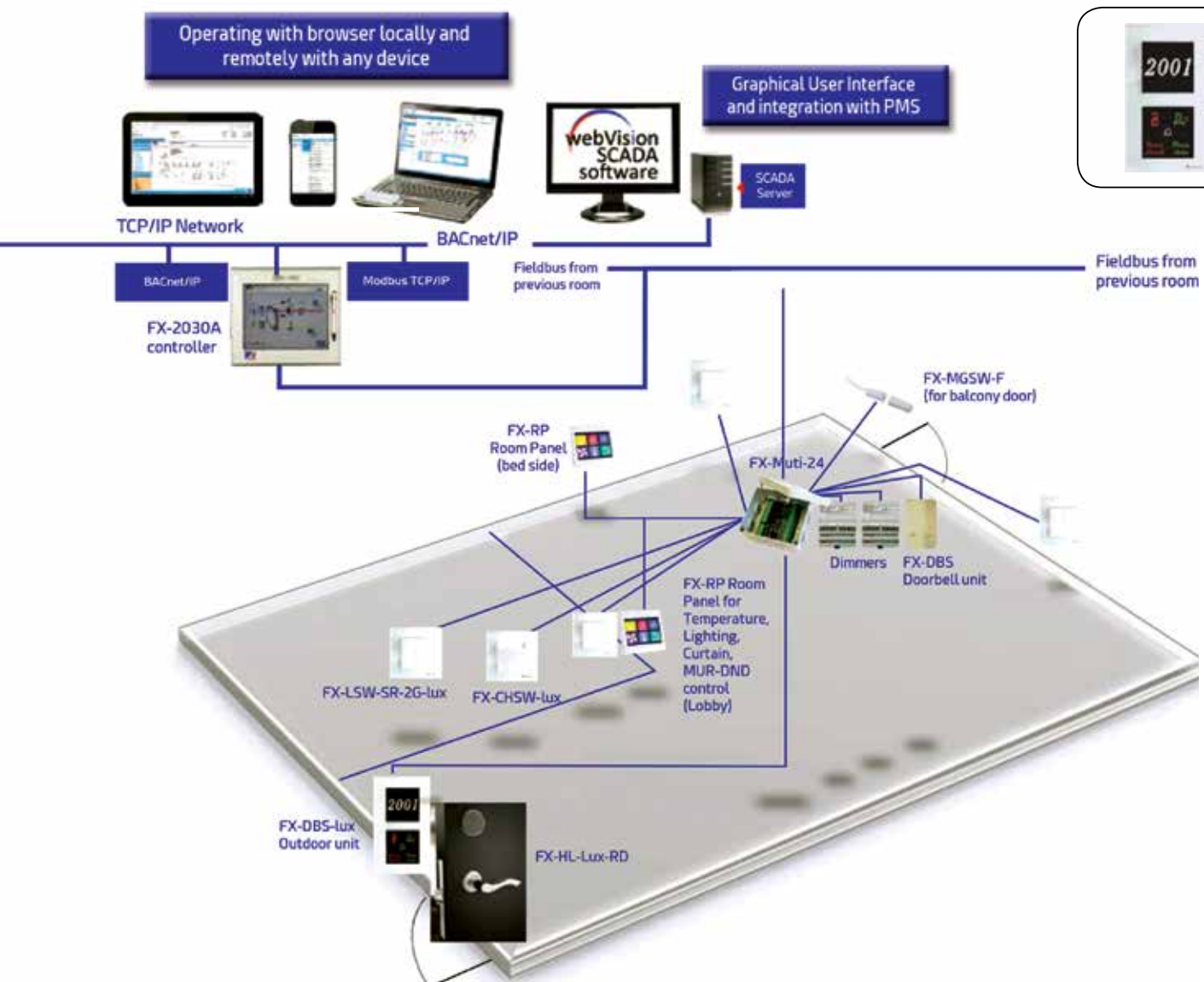
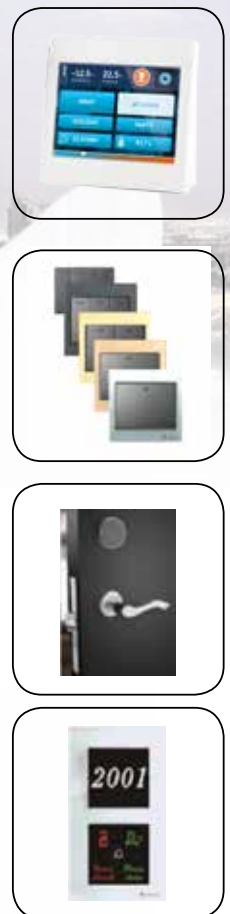



EDGE

Technical Solutions L.L.C



HEAD OFFICE - DUBAI

63B, 6th Floor, Office Block B
Zomorrodah Tower, Karama, UAE.
T : +971 4 370 6172 F: +971 4 370 6173
E : info@edge-ts.net
www.edgetechnicalsolutions.com
W: www.edgefiresolutions.com

SHARJAH

4th Floor Office No. 4023-2
Mega Mall Tower
Mob : +971 55 337 1754

ABU DHABI

Office No. C11
Al Istikanà Cafe Bldg. Musaffah-44
T : +971 2 554 6303

QATAR

Dira Commercial Building No.1
Old Al Ghanim Area, P.O. Box 30103
Area 6, Street 948, Doha

SAUDI ARABIA DAMMAM

EDGE TECHNICAL TRDG. EST.
P.O. Box 20085, Al Khobar 31952
King Faisal Bin Abdul Aziz Road
Mob: +966 55 385 2526



TOLL FREE
800 EDGE (3343)



edgetechnicalsolution



edgesolutions1



edgetechnicalsolutions



edgetechnicalsolutions